

## Split-core current transformer, type KBU



### Features / benefits

- Perfect for subsequent assembly into already existing installations
- Easy and safe mounting, due to hearable locking system
- Deliverable with secondary current 5 A / 1 A
- Deliverable also in accuracy class 0.5
- Four different construction types

### General technical specifications

- Operating temperature:  $-5^{\circ}\text{C} < T < +40^{\circ}\text{C}$
- Storage temperature:  $-25^{\circ}\text{C} < T < +70^{\circ}\text{C}$
- Therm. nominal continuous rated current  $I_{cth}$ :  $1.0 \times I_N$
- Therm. nominal short-time current  $I_{th}$ :  $60 \times I_N$ , 1 sec.
- Max. operating voltage  $U_m$ : 0.72 kV
- Isolation test voltage: 3 kV,  $U_{eff}$ , 50 Hz, 1 min.
- Rated frequency: 50 Hz
- Isolation class: E
- Applicable technical standard: DIN EN 61869, part 1 + 2

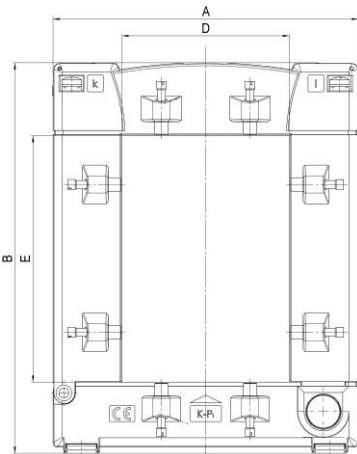

### Dimensions

Type	A (width) [ mm ]	B (height) [ mm ]	C / C1 (depth) [ mm ]	D [ mm ]	E [ mm ]	F [ mm ]	G [ mm ]
KBU 23	93	106	34 / 58	23	33	64	56
KBU 58	125	158	34 / 58	55	85	96	56
KBU 812	155	198	34 / 58	85	125	126	56
KBU 816	195	243	64 / 79	85	165	156	62

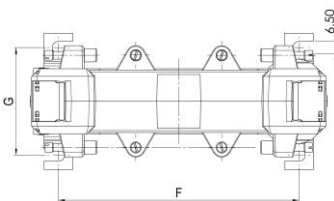
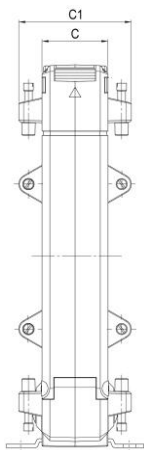

## Order list KBU 23

Secondary current		5 A			1 A		
Primary current [ A ]	Burden [ VA ]	Accuracy class			Accuracy class		
		3	1	0.5	3	1	0.5
		Art.-no.	Art.-no.	Art.-no.	Art.-no.	Art.-no.	
100	1.25	80048			80248		
150	1.5	80030			80230		
200	2.5	80031			80231		
250	1.5		80044			80244	
300	3.75		80045			80245	
400	1			80037			80237
	5		80046			80246	

## Order list KBU 58

Secondary current		5 A		1 A	
Primary current [ A ]	Burden [ VA ]	Accuracy class		Accuracy class	
		1	0.5	1	0.5
		Art.-no.	Art.-no.	Art.-no.	Art.-no.
250	1.5	80061		80261	
300	2.5	80062		80262	
400	1		80038		80238
	2.5	80063		80263	
500	2.5		80054		80254
	5	80064		80264	
600	2.5		80055		80255
	5	80065		80265	
750	2.5		80056		80256
	5	80066		80266	
800	2.5		80057		80257
	7.5	80067		80267	
1000	5		80058		80258
	10	80068		80268	

## Order list KBU 812

Secondary current		5A		1A	
Primary current [ A ]	Burden [ VA ]	Accuracy class		Accuracy class	
		1	0.5	1	0.5
		Art.-no.	Art.-no.	Art.-no.	Art.-no.
250	1.5	80091		80291	
300	2.5	80092		80292	
400	2.5	80093		80293	
500	2.5		80074		80274
	5	80094		80294	
600	2.5		80075		80275
	5	80095		80295	
750	2.5		80076		80276
	2	80096		80296	
800	2.5		80077		80277
	7.5	80097		80297	
1000	5		80078		80278
	10	80098		80298	
1200	5		80079		80279
	10	80099		80299	
1250	7.5		80080		80280
	15	80100		80300	
1500	7.5		80081		80281
	15	80101		80301	

## Order list KBU 816

Secondary current		5A		1A	
Primary current [ A ]	Burden [ VA ]	Accuracy class		Accuracy class	
		1	0.5	1	0.5
		Art.-no.	Art.-no.	Art.-no.	Art.-no.
1000	10	80140	80110	80340	80310
	15	80141		80341	
1200	10	80142	80111	80342	80311
	15	80143		80343	
1500	10	80144	80112	80344	80312
	15	80145	80113	80345	80313
1600	10	80146	80114	80346	80314
	15	80147	80115	80347	80315
2000	10	80148	80116	80348	80316
	15	80149	80117	80349	80317
2500	10	80150	80119	80350	80319
	15	80151	80120	80351	80320
3000	15	80152	80122	80352	80322
	30	80153		80353	
4000	15	80154	80123	80354	80323
	30	80155	80124	80355	80324
5000	15	80156	80125	80356	80325
	30	80157	80126	80357	80326